

Harmony[®] XAC pendant control stations

Catalog

June 2013



Pendant control stations

Complete stations "ready for use"

Applications

- Motor control
- Single-speed
 - 2-speed
 - Emergency stop

Control circuits

Simple hoisting: 1 movement	Handling-hoisting: 2 movements
-----------------------------	--------------------------------

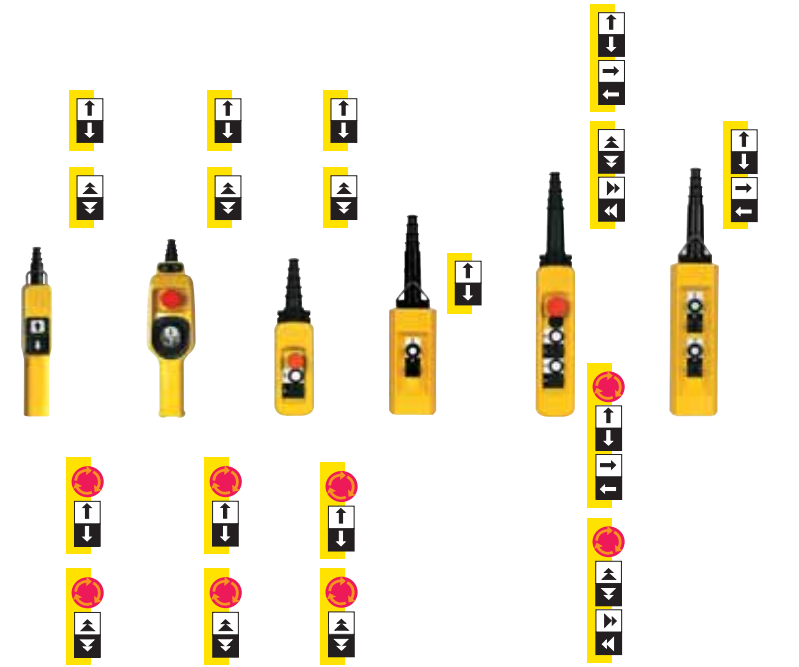

Number of operators	2	1 (2-directional)	2	2	4	4
Enclosure material	Polypropylene			Polyester	Polypropylene	Polyester
Shock resistance	100 gn	70 gn	100 gn			
Conformity to standards	EN/IEC 60947-5-1, EN/IEC 60204-32, UL 508, CSA 22-2 N° 14 and EN/IEC 60947-5-5, EN/ISO 13850 (1)			EN/IEC 60947-5-1 CSA 22-2 N° 14	EN/IEC 60947-5-1, EN/IEC 60204-32, UL 508, CSA 22-2 N° 14 and EN/IEC 60947-5-5, EN/ISO 13850 (1)	EN/IEC 60947-5-1 CSA 22-2 N° 14
Protective treatment	Standard version, "TH"					
Degree of protection	IP 65					
	IK 08					
Cable entries	Rubber sleeve with stepped entry diameter for cable Ø 7 to 15 mm	Rubber sleeve with stepped entry diameter for cable Ø 7 to 18 mm	Rubber sleeve with stepped entry diameter for cable Ø 8 to 26 mm	Rubber sleeve with stepped entry diameter for cable Ø 7 to 13 mm, Ø 10 to 22 mm, Ø 22 to 35 mm	Rubber sleeve with stepped entry diameter for cable Ø 8 to 26 mm	Rubber sleeve with stepped entry diameter for cable Ø 7 to 13 mm, Ø 10 to 22 mm, Ø 22 to 35 mm
Pendant station type reference	XACA	XACD	XACA	XACB	XACA	XACB

(1) For versions with trigger action Emergency stop.

Handling-hoisting: 3 movements

Power circuits

Simple hoisting: 1 movement	Handling-hoisting: 2 movements	3 movements
-----------------------------	--------------------------------	-------------

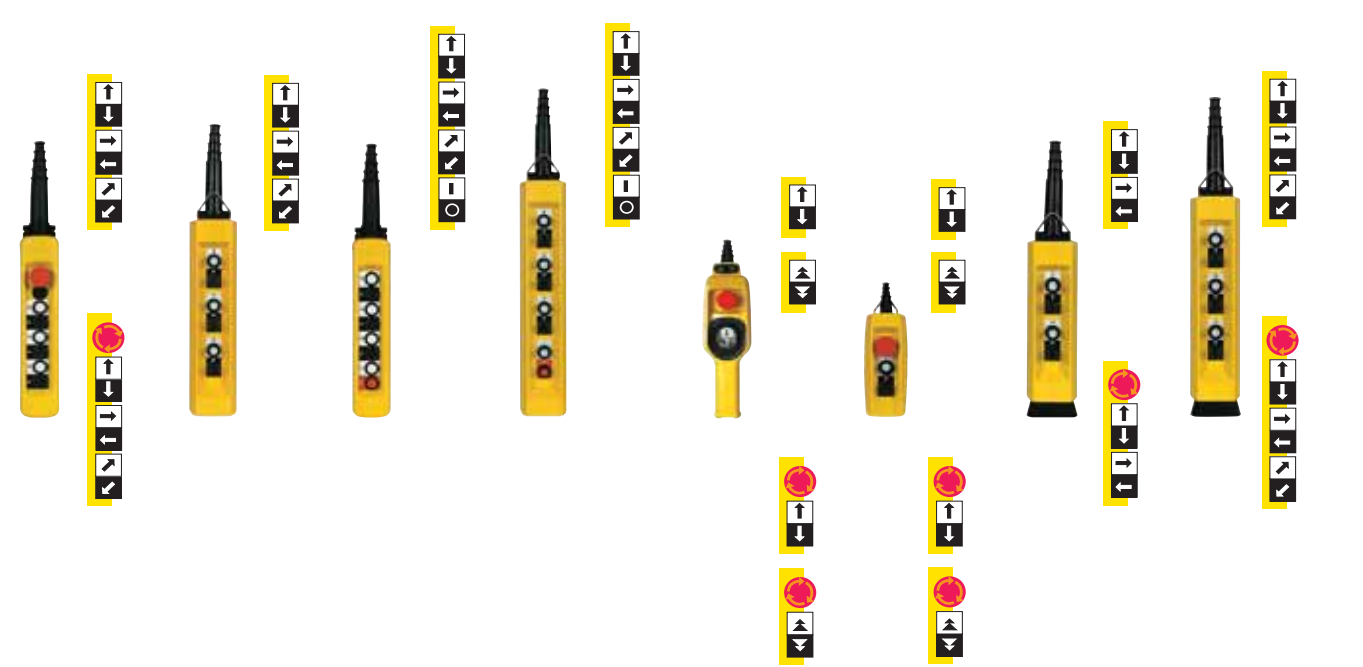

6	6	8	8	1 (2-directional)	2	4	6
Polypropylene	Polyester	Polypropylene	Polyester	Polypropylene	Polyester		
100 gn				100 gn			
EN/IEC 60947-5-1, EN/IEC 60204-32, UL 508, CSA 22-2 N° 14 and EN/IEC 60947-5-5, EN/ISO 13850 (1)	EN/IEC 60947-5-1 CSA 22-2 N° 14	EN/IEC 60947-5-1, EN/IEC 60204-32, UL 508, CSA 22-2 N° 14 and EN/IEC 60947-5-5, EN/ISO 13850 (1)	EN/IEC 60947-5-1 CSA 22-2 N° 14	EN/IEC 60947-5-1, EN/IEC 60204-32, UL 508, CSA 22-2 N° 14, EN/IEC 60947-3 and EN/IEC 60947-5-5, EN/ISO 13850 (1)			
Standard version, "TH"				Standard version, "TH"			
IP 65				IP 65			
IK 08				IK 08			
Rubber sleeve with stepped entry diameter for cable Ø 8 to 26 mm	Rubber sleeve with stepped entry diameter for cable Ø 7 to 13 mm, Ø 10 to 22 mm, Ø 22 to 35 mm	Rubber sleeve with stepped entry diameter for cable Ø 8 to 26 mm	Rubber sleeve with stepped entry diameter for cable Ø 7 to 13 mm, Ø 10 to 22 mm, Ø 22 to 35 mm	Rubber sleeve with stepped entry diameter for cable Ø 7 to 18 mm	Rubber sleeve with stepped entry diameter for cable Ø 10 to 22 mm		
XACA	XACB	XACA	XACB	XACD	XACB	XACB	XACB

Pendant control stations

Variable composition stations

Applications	Control circuits		
Number of cut-outs	1 or 2	2, 3, 4, 5, 6, 8 or 12	2, 3, 4, 6, 8 or 12 in 1 row or 2 rows of 6



Enclosure material	Polypropylene	Polyester	
Shock resistance	Conforming to standard IEC 60068-2-27		
Conformity to standards	EN/IEC 60947-5-1, EN/IEC 60204-32, UL 508, CSA 22-2 N° 14, EN/IEC 60947-3 and EN/IEC 60947-5-5, EN/ISO 13850 (1)		
Protective treatment	Standard version, "TH"		
Degree of protection	Conforming to standard IEC 60529		
	Conforming to standard EN 50102		
Equipment	<ul style="list-style-type: none"> b Emergency stop (front mounted) b Contact blocks for 1 or 2 speeds 	<ul style="list-style-type: none"> b Pushbuttons b Selector/key switches b Pilot lights b Emergency stop (front or base mounted) b Wobblesticks b Contact blocks for 1 or 2 speeds 	<ul style="list-style-type: none"> b Pushbuttons b Selector/key switches b Pilot lights b Emergency stop (front or base mounted) b Wobblesticks b Contact blocks for 1 or 2 speeds
Cable entries	Rubber sleeve with stepped entry diameter for cable Ø 7 to 18 mm	Rubber sleeve with stepped entry diameter for cable Ø 8 to 26 mm	Rubber sleeve with stepped entry diameter for cable Ø 10 to 22 mm
Pendant station type reference	XACD	XACA	XACB

(1) For versions with trigger action Emergency stop.

Applications	Power circuits	
Up to 30	1 or 2	2, 3, 4, 6, 8 or 12 in 2 rows of 6



Enclosure material	Polyester	Polypropylene	Polyester
Shock resistance	Conforming to standard IEC 60068-2-27		
Conformity to standards	EN/IEC 60947-5-1, EN/IEC 60204-32, UL 508, CSA 22-2 N° 14, EN/IEC 60947-3 and EN/IEC 60947-5-5, EN/ISO 13850 (1)		
Protective treatment	Standard version, "TH"		
Degree of protection	Conforming to standard IEC 60529		
	Conforming to standard EN 50102		
Equipment	<ul style="list-style-type: none"> b Pushbuttons b Selector/key switches b Pilot lights b Emergency stop (front or base mounted) b Wobblesticks b Contact blocks for 1 or 2 speeds 	<ul style="list-style-type: none"> b Emergency stop (front mounted) b Contact blocks for 1 or 2 speeds 	<ul style="list-style-type: none"> b Pushbuttons b Selector/key switches b Pilot lights b Emergency stop (front or base mounted) b Wobblesticks b Contact blocks for 1 or 2 speeds
Cable entries	Rubber sleeve with stepped entry diameter for cable Ø 10 to 22 mm and Ø 22 to 35 mm	Rubber sleeve with stepped entry diameter for cable Ø 7 to 18 mm	Rubber sleeve with stepped entry diameter for cable Ø 10 to 22 mm
Pendant station type reference	XACF	XACD	XACB

Pendant control stations

Double insulated with intuitive operation,
type XACD

For control or power circuits

Variable composition stations, factory assembled

2

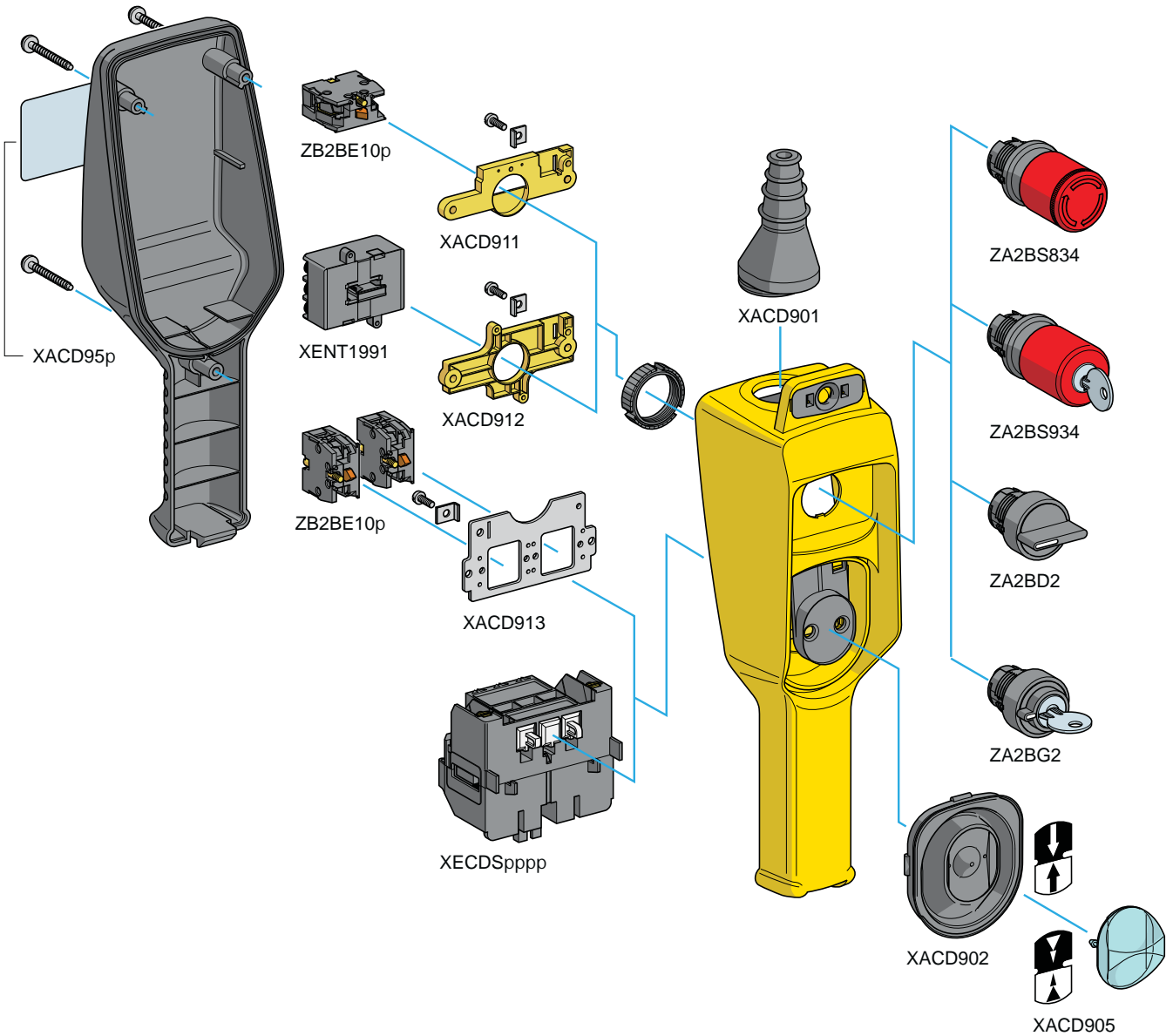

Pendant control stations

Double insulated, type XACA

For control circuits

Variable composition stations, factory assembled

3

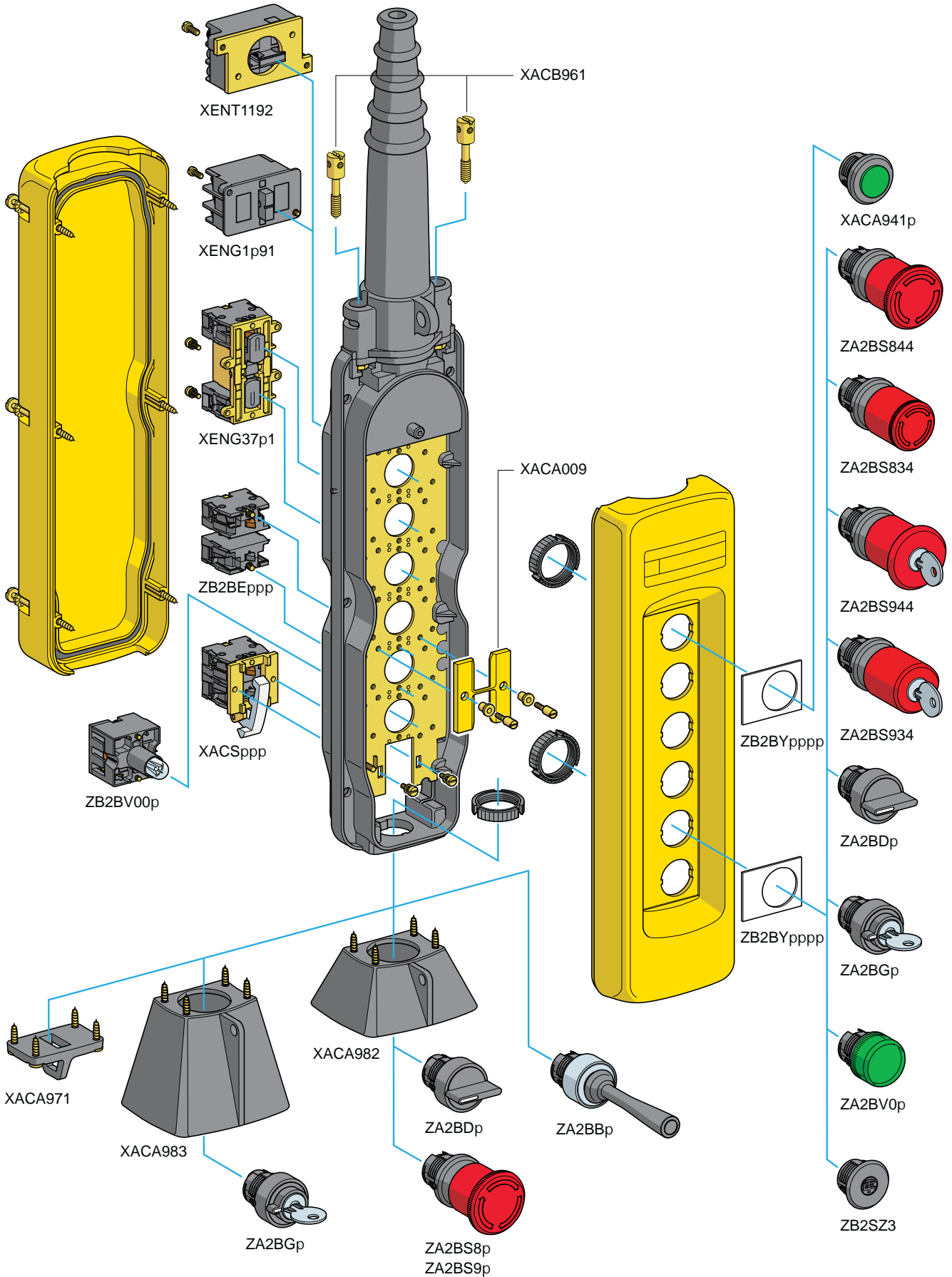

Pendant control stations

Double insulated, type XACB

For control or power circuits

Variable composition stations, factory assembled

3

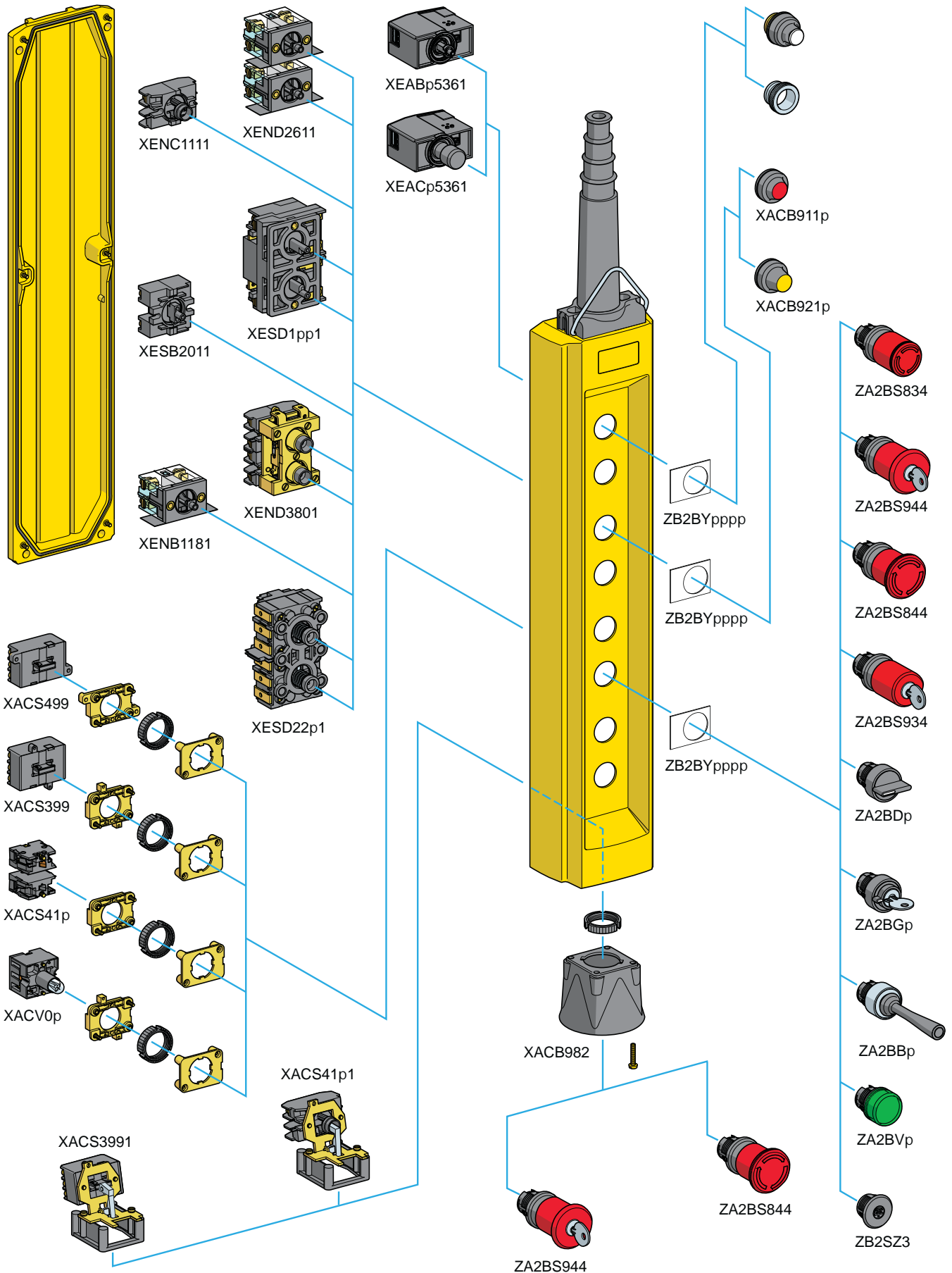

Control Station

Pendant Station



- Highly robust pendant control stations
- Conformity with the safety requirements of IEC standards
- 1 or 2 speed up, down, right, and left movements; emergency stop option available
- CE marking , UL/CSA certification
- Complete products IP65
- Double insulated polypropylene casing
- Screw clamp connection

Control station composition	Mechanical interlocking	Contact composition	Reference	Unit MRP [₹]
For Single Hoist Motors				
2 pushbuttons	With mechanical interlocking	1 NO	XACA201	5709
	With mechanical interlocking	1 NC + 1 NO	XACA205	6018
2 booted pushbuttons	With mechanical interlocking	1 NO	XACA211	5765
	With mechanical interlocking	1 NC + 1 NO	XACA215	6569
For Single-Speed Motors				
2 pushbuttons	With mechanical interlocking	1 NO	XACA271	5855
	With mechanical interlocking	1 NC + 1 NO	XACA281	6591
4 pushbuttons	With mechanical interlocking Between pairs	1 NO	XACA471	7464
	With mechanical interlocking Between pairs	1 NC + 1 NO	XACA481	8475
6 pushbuttons	With mechanical interlocking Between pairs	1 NO	XACA671	8724
	With mechanical interlocking Between pairs	1 NC + 1 NO	XACA681	10771
8 pushbuttons	With mechanical interlocking Between pairs	1 NO (for 7 operators) 1 NO (for 8 operators)	XACA871	10219
	With mechanical interlocking Between pairs		XACA881	12780

Joystick Controllers

Description	Legend plate without text	Legend plate Price	Reference	Unit MRP [₹]
XD2-P (One Step in Each Position) Dia. 22mm				
2-Direction Stay-Put	ZD2-GY2201	103	XD2PA12	6507
2-Direction Spring Return to Zero	ZD2-GY2201	103	XD2PA22	6024
4-Direction Stay-Put	ZD2-GY4201	123	XD2PA14	7442
4-Direction Spring Return to Zero	ZD2-GY4201	123	XD2PA24	7560
XD2-G (Two steps in each position) Dia. 22mm				
2 - Direction (2 notches with spring return to zero)	ZD2-GY5201	139	XD2GA8241	14445
4-Direction spring (2 notches with spring return to zero)	ZD2-GY6201	146	XD2GA8441	19057

Foot Switch

Contacts Type and Composition	Reference	Unit MRP [₹]
Insulated Enclosure 1 NC + 1 NO	XPEA110	6016

Please contact Customer Care Center for Stockable and Non stockable status of references.

NORMAL STOCK ITEMS

W.E.F. January 17th, 2024